

Makina Kalıp Plastik San. Tic. Ltd. Şti.
(Kurtköy / İstanbul)

Kalıp Üretimi ve Plastik Enjeksiyon Konusunda

Yüksek Teknolojiye Sahip Mühendislik ve Çözüm Ortağınız

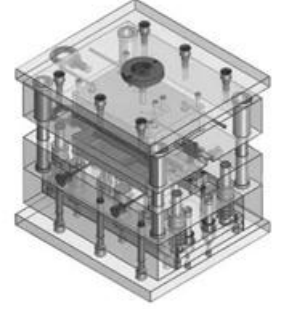

Enjeksiyon & Kesme Kalıpları Üretimi

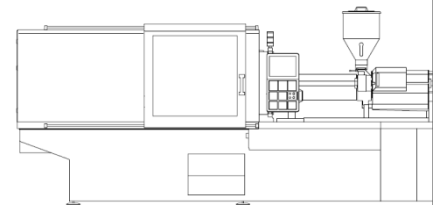

Plastik Enjeksiyon Parça Üretimi

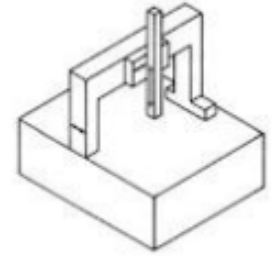

CMM Ölçüm Teknolojisi

info@makkalip.com
www.makkalip.com.tr
info@makkalip.com
www.makkalip.com.tr
info@makkalip.com
www.makkalip.com.tr
info@makkalip.com
www.makkalip.com.tr
info@makkalip.com
www.makkalip.com.tr

MAKİNA PARKIMIZ

No	Makina Tipi	Marka	Model	Menşey	Üretim Yılı	Efektif Ölçü	Diğer Teknik Bilgi
1	CMM	DEA	Global Performance	İtalya	2012	700x700x500	Maks. Parça ağırlığı 900kg PCDMIS CAD++ Yazılımı

5) CMM (DEA Global Performance)



Models	Strokes (mm)			Classic	Performance	Advantage	SF
	X	Y	Z				
05.05.05	500	500	500	✓	✓	×	×
05.07.05	500	700	500	✓	✓	✓	×
07.07.05	700	700	500	✓	✓	✓	✓
07.10.05	700	1000	500	✓	✓	✓	✓
07.10.07	700	1000	660	✓	✓	✓	✓
09.12.08	900	1200	800	✓	✓	✓	✓



GLOBAL Performance 07.07.05, 07.10.05, 07.10.07

Probe Configuration	Standard Temperature Range 18 ÷ 22°C			CLIMA Temperature Range 16 ÷ 26°C			Max. 3D Speed (mm/s)	Max. 3D Accel. (mm/s ²)
	MPE _E	MPE _p	MPE _{THP/z}	MPE _E	MPE _p	MPE _{THP/z}		
TS-m, TS-sm/TS-p, TS-mp, TP20	1.9 + L/333	2.0	–	2.2 + L/250	2.0	–	516	1700
TS-m, TS-sm/TP200	1.7 + L/333	1.9	–	1.9 + L/250	1.9	–	516	1700
TS-m, TS-sm/LSP-X1s, LSP-X1m	1.5 + L/333	1.6	2.9/68	1.7 + L/250	1.6	2.9/68	516	1700
LSP-X3	1.5 + L/333	1.6	2.9/68	1.7 + L/250	1.6	2.9/68	516	1300